

www.silgan-closures.com

Product Specification

Product Reference: P382VTN, P382VTP

Description: 38mm 2 Lead Tethered Hot Fill Closure

1. Description and Suitability

The 38mm 2 lead-Hot Fill closure has been designed for a 38mm 2-Start neck finish. The primary seal is created by top face seal utilising TPE sealing profile in the roof of the cap. The primary seal is the TPE sealing material compressed onto the top of the bottle neck during application. Tamper Evidence is provided by the combination of a moulded & slit drop down retained ring which includes the Tether design, which does not detach from the closure upon initial opening. And incorporates a lock back to keep the closure at a suitable open position for drinking directly from the bottle. It is suitable for specific neck finish PET containers, designed for hot fill operations.

Caps are available as undecorated (P382VTN), embossed and debossed versions (P382VTP).

Caps are designed with 120 knurls and two pull up marks for recognition and confirmation of application control.

2. Limitations

This product is not suitable for use with alcoholic beverages, carbonated products, high fat content products or products to be stored below 0 degrees C.

Compatible with a specific group of neck finishes. (Conformity provided upon review & application). Details can be provided along with neck finish drawings. **Recommended Neck Finish Ref: APPE Ref-V07.**

3. Reference Dimensions

Amax (at 6.5mm)	39.7mm	Thread: E	35.60mm	Height: H	16.00mm
TT	N/A	OD max	41.7mm	Part weight range	3.1-3.3g

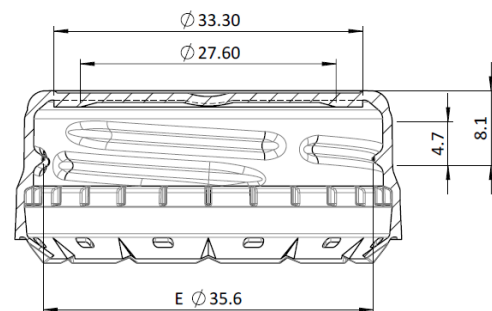
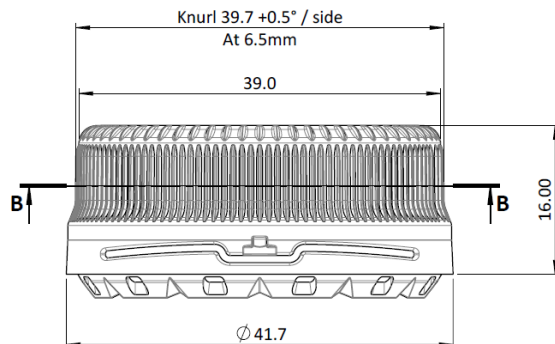

4. Packaging

Cartons

- 2500 closures per bag, 1 bag per box
- Industrial pallet 1200 x 1000 mm 25 boxes per pallet (72,500 closures) or
- Euro pallet 1200 x 800 mm 20 boxes per pallet (58,000 closures)
- Cartons are standard board containing PE liner bag closed (folded), outer board is sealed by tape
- Carton / label identification – Each filled carton will display the name of manufacturer, date of manufacture, product identification code, name, colour code, quantity, box number and best before date

5. Materials and recycling

All materials used in the process are fully approved for direct food contact and meet the requirements of all relevant EU directives and the FDA (Food and Drug Administration).

Date	Issued by	Approved by
05/05/2024	DON Quality Manager	COR Technical Director

Whilst the supplier, Silgan Closures, takes every precaution and uses both their experience and that of their suppliers in the selection of materials and processing of the product, it is deemed ultimately the responsibility of the client to confirm and maintain tests which assure compatibility with the product and mating items in respect of (but not limited to) integrity of product, security and transportation of package, taint and smell.

The supplier's responsibility shall be restricted to notification of proposed changes in conditions or materials, which may require secondary testing and customer approval.

The closures are made of PP & TPE and as such may be recycled after use. Unless otherwise stated no post-consumer recycled material is used in the manufacture of these closures.

6. Recommended storage

- All closures are aged at Silgan and are ready for usage at the time they are received, unless the pallet label indicates otherwise, however closures should be acclimatised at ambient filling line atmosphere 48 hours before use
- Store in a dry, dust free environment
- Production shall be rotated on a "first in first out" basis
- Product should not be stored where it is subject to water damage or exposure to chemicals or odour
- Keep the cartons closed and taped and bags knotted at all times until immediately prior to use, if less than a full carton is to be used, the bag containing the remaining closures should be retied and the top flaps of the carton secured to prevent contamination
- Avoid pallet double stacking which may cause damage to packaging or product within
- Warehouse temperatures should be maintained at 25°C, avoid temperature extremities keep away from temperatures below 5°C and above 30°C
- It is further recommended that the caps are stored in temperatures between 10°C and 30°C 24 hours prior to use
- Shelf life is subject to correct application, storage and temperature limits as shown
- Silgan recommends that under the proper storage, conditions like mentioned below, closures should be used within 1 year of manufacturing.
- The warehouse floor should be levelled and horizontal so that pallets will stand firmly in dry conditions
- Pallets must be handled carefully to avoid extreme stresses or impacts and may not be pushed by fork lifters or similar transport devices

7. Application and usage

It is extremely important to ensure lines are suitable for the application of the cap. This will assure the user of efficiency of application as well as assure later correct functioning and packaging integrity.

It is highly recommended that detailed pre and post commissioning is undertaken to establish suitability of the equipment and process prior to commercial production.

- If fed to hopper/sorter to be via belt convey or with flights used ensure there are no trap points as to cause damage
- Sorter to ensure smooth feed with no trap points to cause jam-ups or damage to closures. Sorter should be able to sort the caps at both extremes of height allowance
- Chute to be constructed to ensure closures feed freely without being able to jam or overlap
- Application of cap should be consistent in feed and height position of cap. The use of a pre spin finger and ski plate to engage threads is recommended to ensure the cap is not dislodged as the bottle is transferred to the capping turret pedestals
- Capping heads should be adjustable to enable correct application on the bottle
- Capping chucks should be designed for the relevant closure, advise on design can be provided by Silgan CTS team
- Bottle handling should be able to control bottles to resist turning as torque is applied

Alignment of head to closure during pick off and closure to container during application are the key ingredient to efficient capping. Silgan have a CTS team to advise and support customers in relation to line suitability and conditions.

Note: The neck finish and container quality is required to be in compliance with the relevant drawings and specification. Silgan need to validate the compatibility of the neck finish of choice with the relevant closure.

Date	Issued by	Approved by
05/05/2024	DON Quality Manager	COR Technical Director

Silgan can assist in the specification and supply of required application, inspection and test equipment.

Compatible neck finish drawings: **APPE Ref V07 (E-10-173.07 L2)** Drawing available upon request.

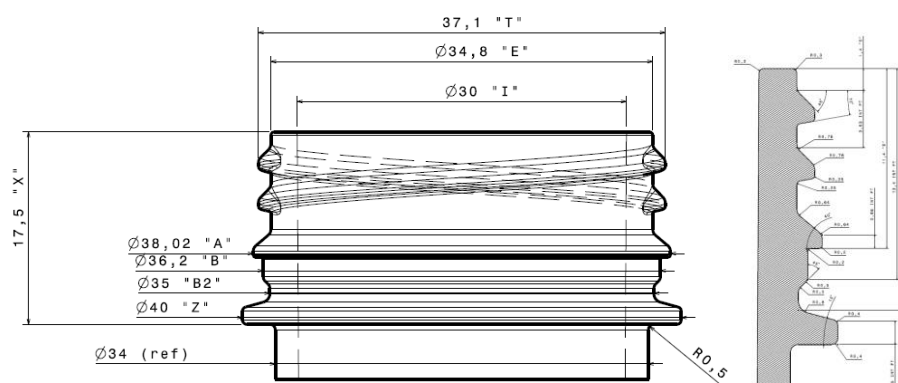

8. Functional characteristics

This product has the following functional characteristics:

Functionality	Detail document
Tamper evidence	LOU_FNC_SPEC P382CXN-P Tamper Evidence
SUP Tether Compatibility	LOU_FNC_SPEC P382CXN-P SUP Tether Compatibility

9. Conditions of Warranty and Liability

The conditions and limitations of Silgan Closures' warranty and liability for the product are specified in the General Terms of Sale and Delivery of the Silgan Closures Group, a copy of which is available upon request and on our website www.silgan-closures.com.

Silgan Closures take every precaution and use their experience and that of their suppliers in the selection of materials and processing of the product. However it is expressly the responsibility of the customer to ensure correct and maintained application control and verify compatibility of the product for their intended use.

Silgan Closures disclaims liability for damage which directly or indirectly results from the failure of the customer to comply with the provisions of this Product Specification and Processing Guideline.

Prior to commercialisation and placing of orders a copy of this Document along with Silgan Terms and Conditions should be signed and sent back to Louny.Quality.Enquiries@silgan-closures.com

Please sign and return this page within 14 days of receipt of the specification.

If after a total of 28 days from the receipt of the specification we have not received either a signed copy of the specification or discussed and recorded any derogation or deviation from this specification, we will deem that the specification has been accepted. No further contact regarding formal approval of this specification will be made.

Specification Agreement and Authorisation				
Supplier	Name	Position	Signature	Date
Silgan Closures	Ross Howson	Quality Manager		07/05/2024
Customer	Name	Position	Signature	Date

Date	Issued by	Approved by
05/05/2024	DON Quality Manager	COR Technical Director